



Installation guide

Electric 3-way valve

Type CTR 20

UK
CA

Main application: Heat reclaim	Refrigerant: R744 for other refrigerants contact Danfoss	Ambient temperature: Min. -40 °C / -40 °F Max. 60 °C / 140 °F	Fluid temperature: Min. 0 °C / 32 °F Max. 150 °C / 302 °F
Stepper motor type: Bipolar		Max working pressure: 140 Bar / 2030 psig	Total full steps: 6600
Phase Current: 100 mA RMS / 141 mA Peak		Coil resistance: 52 Ohm ±10% (25 °C)	Step rate: 75 stp./sec.
 Note! Valves are delivered in approximately half opened position and is ready for brazing.		 Warning! Do not connect directly to AC / DC power source. Connect valve to appropriate controller/driver only. Do not operate valve while assembling or disassembling.	

Flow direction

A.

1 in 2 outs

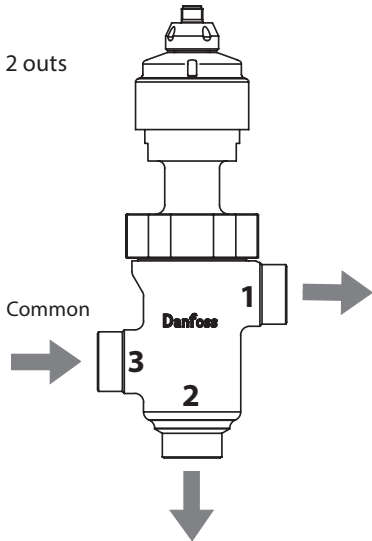

B.

2 in 1 out

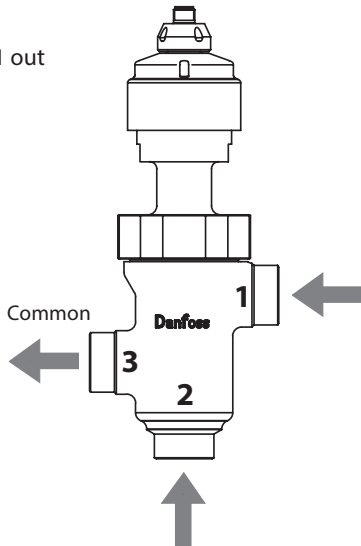

For more information on the product,
please scan the QR code.

Mounting direction

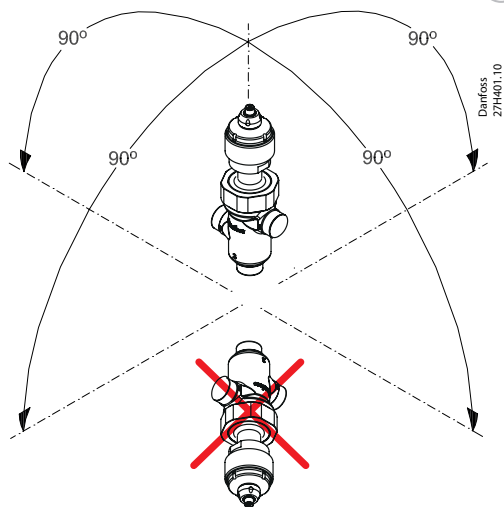

- Do not disassemble the valve before brazing or welding.
- the valve must be in middle position by brazing and welding (as it is delivered).

Brazing

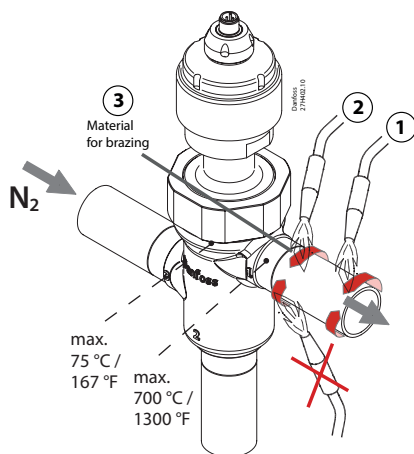

Recommendation: Solder nozzle 4 - 6 mm N (5/32 in - 15/64 in)

Materials used for brazing:

- Flux: Metalli tenacity No. 5 Powder or Braze Tec special h paste.
- Filler: Silver-Flo 55 (BS:AG 14/ DIN L-Ag55 Sn) or Silver-Flo 56 (AWS B Ag-7).



Filler metals containing Phosphor i.e. BS: CP 1/ DIN L-Ag 15P or BS: CP 3/ DIN L-Ag P7 must not be used.

Welding

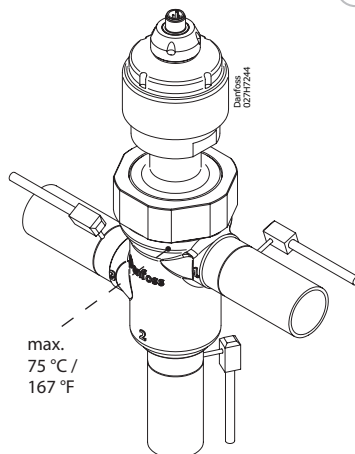

Recommendation for TIG welding

- Power approximately 60A.
- Use Shield gas charge - Argon.
- Material for welding - approximately 2 mm thick stainless steel alloy.

Electrical connections

4

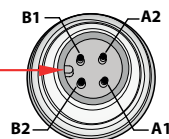
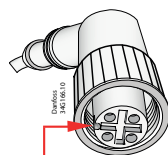
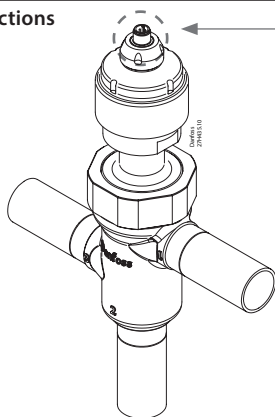

M12 connection
on CTR valve

A1 and A2 = coil I
B1 and B2 = coil II

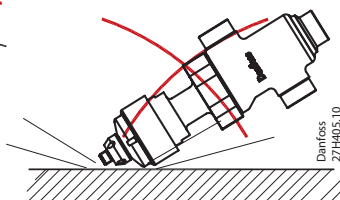
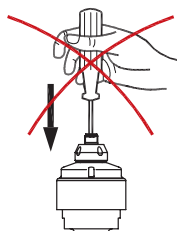
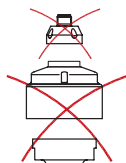
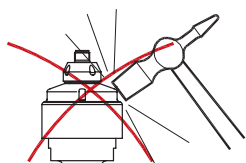

For your own notes

Service only

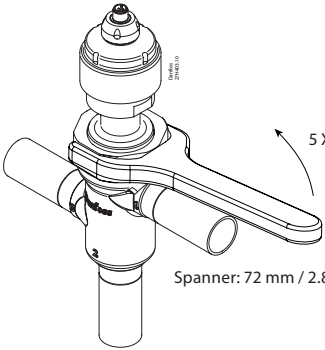
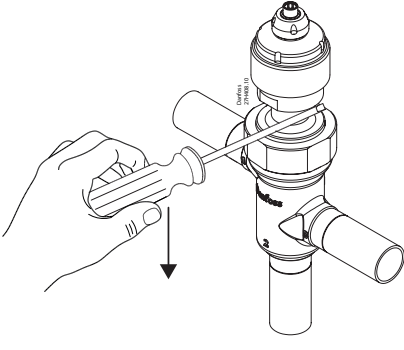
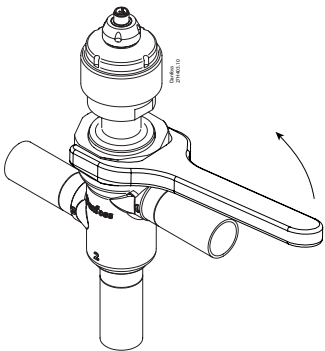
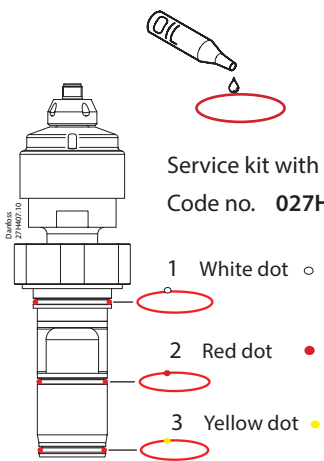
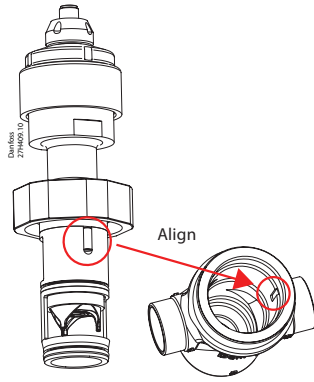
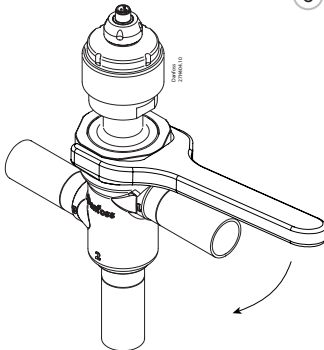
<p>1</p>  <p>Spanner: 72 mm / 2.8 in</p> <p>5 X</p> <p>Unskrew the big nut with 5 rotations</p>	<p>2</p>  <p>Lift the motor with a screwdriver untill it is loose</p>
<p>3</p>  <p>Unscrew the big nut fully</p>	<p>4</p>  <p>Service kit with 3 O-rings Code no. 027H7248</p> <p>1 White dot ○</p> <p>2 Red dot ●</p> <p>3 Yellow dot ●</p>
<p>5</p>  <p>Align</p> <p>The "fixing" pin must be placed in the gap</p>	<p>6</p>  <p>Max. torque: 130 Nm/ 95.9 ft-lbf</p>